

LED LANDSCAPE LIGHT

OPERA

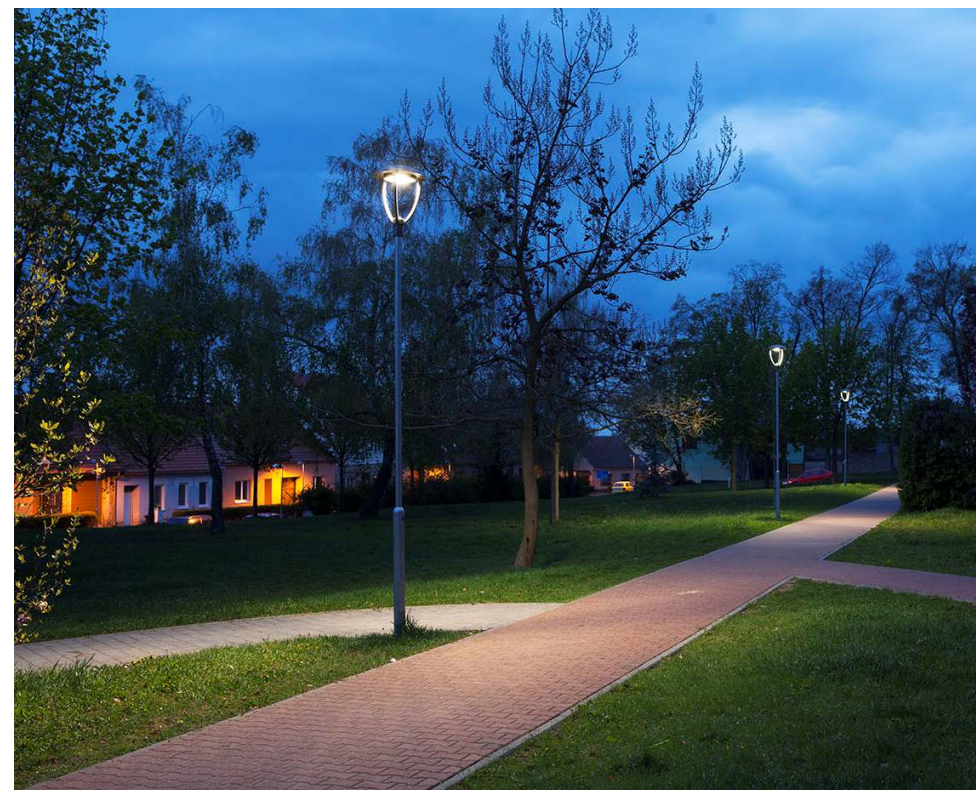

TOGETHER, FOR A BRIGHTER FUTURE



UNILUMIN GROUP CO., LTD

HQ Address: 112 Yongfu Rd., Qiaotou Village, Fuyong Town, Baoan District, Shenzhen 518103 China
 Manufacturing Base: Unilumin Industrial Park, 6 North Lanjing Road Pingshan District, Shenzhen, China
 TEL: +86-0755-29918999 | FAX: +86-0755-29912092 | E-mail: ledlighting@unilumin.com
 www.unilumin.com | www.unilumin-lighting.com

The product designs and specifications are subject to change without prior notice.
 All rights reserved, copy is prohibited without the permission of Unilumin Group Co., Ltd.



Official Website



Facebook



Twitter



LinkedIn



Instagram

Published: October 2023

UNILUMIN GROUP CO., LTD



About Unilumin

Established in 2004, is a world-class LED lighting and display solution provider. As a key business of Unilumin Group, Unilumin Lighting has established a firm foothold in the LED lighting industry and has been a trusted global partner offering comprehensive lighting solutions and exceptional customer service. Our relentless dedication to R&D and customer satisfaction has positioned Unilumin as a top LED lighting brand, known for our worldwide presence and core competitive edges.

Why Choose Unilumin



16 Years of Outdoor Lighting Expertise



ISO/IEC 17025 Accredited LAB & Precise Automatic Production



Flexible Customization Services



Recognized by Clients in Over **80** Countries



Post top



Mast arm



Span wires



Opera Series

Opera is an innovative LED landscape light designed for a better city image with its aesthetic style. With up to 150lm/w luminous efficiency and versatile installation methods, Opera can meet different requirements of customers and is quite popular in parks, courtyards, building entrances, etc.

Features & Benefits

1. Stylish design, enhance the charm and competitiveness of cities
2. Die-casting aluminum housing, reliable and robust
3. Diverse mounting methods for more applications
4. High flexibility with various light distribution options
5. Efficient heat sink structure design, more stable
6. Easy to disassemble, repair and replace
7. Equipped with automatic power-off switch to ensure safety

Application



Residential Street



Pedestrian Path



Park & Square



Tourist attraction



Innovative heat sink design

Enhance the air convection for more efficient heat dissipation

Water-proof silicon gasket

Supreme water-proof performance
less maintenance demands

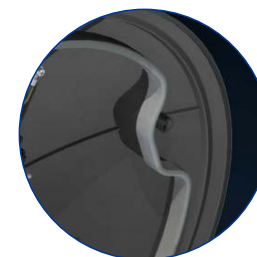

Tool-free access design

Thumb screw design maximize the ease of maintenance

Strong supporting hinge

Support the top cover for more convenient during the maintenance

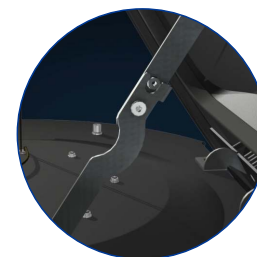

Light Distributions

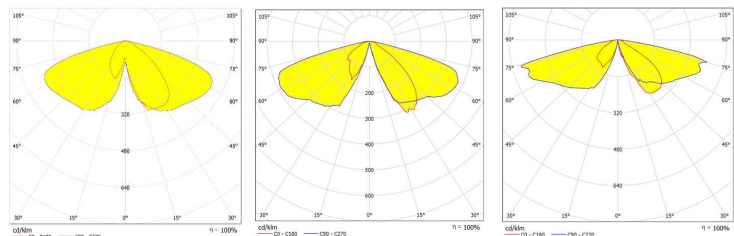

Type II (UNI-482) Type II (UNI-540) Type II (UNI-618)

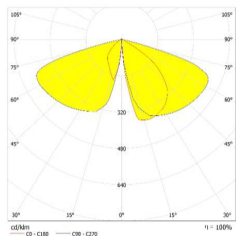

Type II (UNI-677)

3030 Light Source

Power (W)	LED QTY (pcs)	Light Distribution	4000K Ra70@Ta=25°C		3000K Ra70@Ta=25°C	
			Luminaire Efficiency	Luminous Flux	Luminaire Efficiency	Luminous Flux
18	24	UNI-540	110 lm/W	1980 lm	103 lm/W	1848 lm
25	32			2750 lm		2567 lm
35	40			3850 lm		3593 lm
45	48			4950 lm		4620 lm
65	64			7150 lm		6673 lm
80	80			8800 lm		8213 lm

3535 Light Source

Power (W)	LED QTY (pcs)	Light Distribution	4000K Ra70@Ta=25°C		3000K Ra70@Ta=25°C	
			Luminaire Efficiency	Luminous Flux	Luminaire Efficiency	Luminous Flux
18	10	UNI-482	115 lm/W	2070 lm	105 lm/W	1890 lm
25	14			2875 lm		2625 lm
35	20			4025 lm		3675 lm
45	26			5175 lm		4725 lm
65	38			7475 lm		6825 lm
80	48			9200 lm		8400 lm

Power (W)	LED QTY (pcs)	Light Distribution	4000K Ra70@Ta=25°C		3000K Ra70@Ta=25°C	
			Luminaire Efficiency	Luminous Flux	Luminaire Efficiency	Luminous Flux
18	16	UNI-482	125 lm/W	2250 lm	115 lm/W	2070 lm
25	20			3125 lm		2875 lm
35	30			4375 lm		4025 lm
45	40			5625 lm		5175 lm
65	58			8150 lm		7475 lm
80	58			10000 lm		9200 lm

The luminaire efficacies are the typical values, ±7% tolerance is reserved.

Dimensions

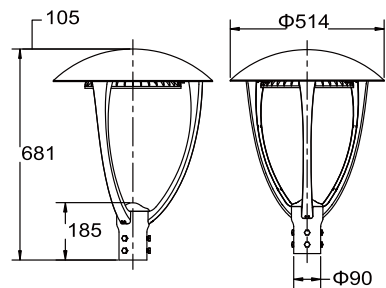

UNI-YA03-1

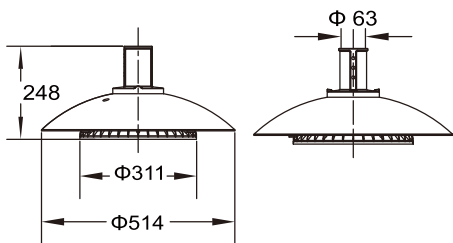

UNI-YA03-2

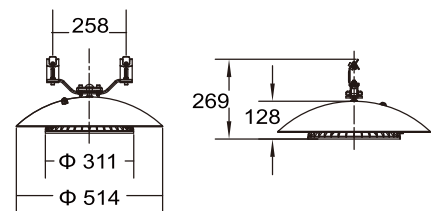

UNI-YA03-3

Parameters



Product Model	UNI-YA03-1	UNI-YA03-	UNI-YA03-3
Input Voltage	AC100-277V 50/60Hz		
Rated Power	18-80W		
Luminous Efficacy	110-150lm/W		
Luminous Flux (lm)	1980-12000		
CCT	3000K/4000K/5000K/5700K/6500K		
CRI	70		
Housing Materials	Die-casting aluminum		
IP / IK	IP66/IK08		
Product Dimension (mm)	514×514×681	514×514×248	514×514×269
Packing Dimension (mm)	590×590×250	590×590×235	590×590×235
Net Weight(kg)	9.2±0.2	7.9±0.2	8.1±0.2
Gross Weight (kg)	12±0.2	8.9±0.2	9.1±0.2

Note: The tolerance of Luminous Flux is ±7%

Controller



Features

- Zigbee communication, auto-Mesh
- With standard NEMA 5 lines interface for easy installation
- Remote switch on/off, maximum internal 16A relay outputs
- With dimming interface: 0-10V (PWM could be customized)
- With current, voltage, power, power factor, electric energy remote reading functions
- With LED lamp failure detection function
- With initiative fault information reporting functions
- Lightning protection function
- IP65



NEMA Socket 5PIN 7PIN

Optical control can be connected to 3/5/7PIN interface.

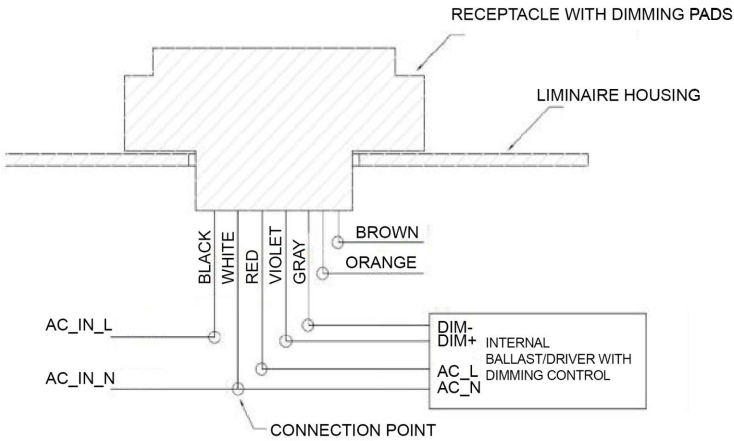

Dimming mode	Output parameters	Explanation	Communication mode	Route pattern	Communication distance	Frequency	Frequency range	Communication rate
Analog voltage	0-10V/10mA	Preset 100% dimming for 10V, or 0V output	Zigbee	MESH	200M (visual range)	2.4GHz	2.4GHz~2.485GHz	250Kbps

