



Econplus II



Color: Dark Gray
(PANTON:8403C)

Features:

- Rated Power: 20W-100W;
- Rated Input Voltage: AC100-277V;
- Housing Material: Die-casting aluminum housing+PC lens;
- Protection Degree: IP66、IK07;
- Applicable stem diameter: $\Phi 60\text{mm}$;
- Operating Environment: Operating Temperature- $40^{\circ}\text{C} \sim 45^{\circ}\text{C}$ 、Operating Humidity $10\% \sim 90\% \text{RH}$ 、Storage Temperature- $40^{\circ}\text{C} \sim 55^{\circ}\text{C}$.

Street Light Specification



Product Model	UNI-STC9-1	UNI-STC9-1	UNI-STC9-1	UNI-STC9-3	UNI-STC9-3	UNI-STC9-3
Power (W)	20	30	50	60	80	100
Luminous Flux (lm)	2600	3900	6500	7800	10400	13000
Power Factor	≥0.92	≥0.92	≥0.92	≥0.95	≥0.95	≥0.95
Input Voltage	AC100-277V 50/60Hz					
LED	Ruifeng 3030					
Driver	Inventronics/Philips/Moso/Sosen					
CCT (K)	4000±300K, 5000±300K					
Luminaire Efficiency@4000K, Ta=25°C (lm/W)	Option:130					
CRI	70					
Working Temp.	- 40 °C ~ 50 °C					
Working Humidity	10 % ~ 90 % RH					
Storage Temp.	- 40 °C ~ 60 °C					
Housing Materials	Die-casting aluminum					
IP Grade	IP66					
IK Grade	IK07					
Life Span (Hrs)	30,000					
Product Dimension (mm)	424X143X78	424X143X78	424X143X78	564x192x80	564x192x80	564x192x80
Packing Dimension (mm)	620X475X385 (10 in 1)	620X475X385 (10 in 1)	620X475X385 (10 in 1)	615X500X4758 (8 in 1)	615X500X4758 (8 in 1)	615X500X4758 (8 in 1)
Net Weight (kg)	1.1	1.15	1.2	1.8	1.85	1.9
Gross Weight (kg)	13.4 (10 in 1)	13.9 (10 in 1)	12.4 (10 in 1)	16.24 (8 in 1)	16.64 (8 in 1)	17.04 (8 in 1)

Note: The tolerance of Luminous Flux for lighting products is ±7%

Products Dimension:

UNI-STC9-1: 424X143X78mm
Micro

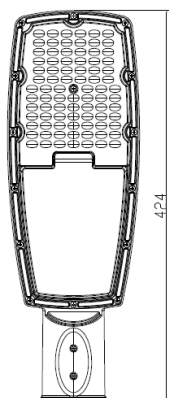
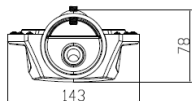

UNI-STC9-3: 564×192×80mm
Mini-plus

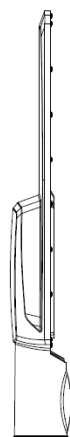
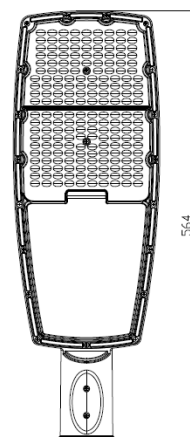
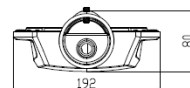

Light Distribution:

UNI-STC9-50

子午面配光曲线

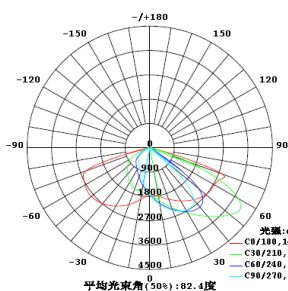

UNI-STC9-100

子午面配光曲线

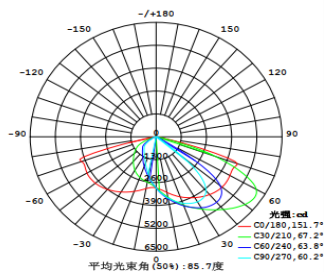

Note: The picture is only a reference for typical light distribution types, and the specific parameters are subject to the actual IES of the product.

Installation Diagram:

1. Connect the reserved power line of the lamp and the power line of the pole correctly as shown in the lower left corner of the figure: L (brown) grounding wire, N (blue) neutral wire, (chartreuse) grounding wire. Waterproof treatment shall be done at the wiring;

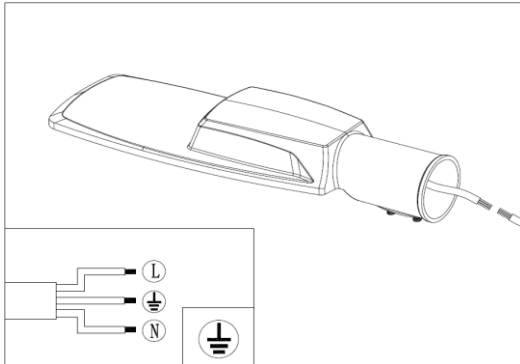

2. Insert the lamp pole arm into the lamp and tighten two M8 screws;

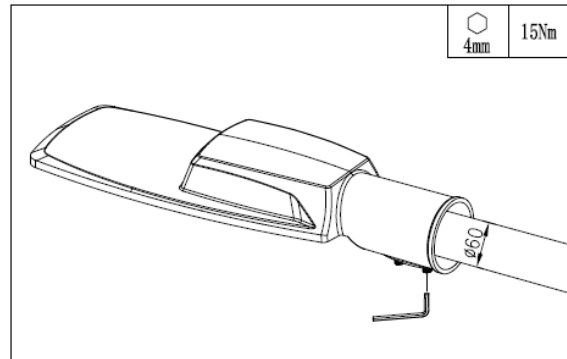

3. Complete installation

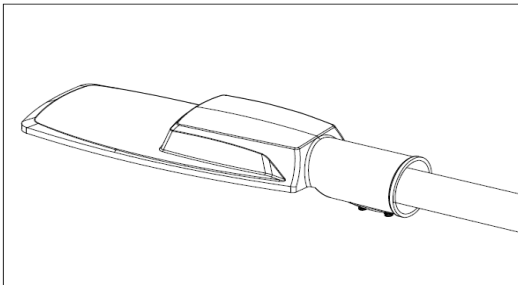

Maintenance:

- For the lifespan and safer use of this product, please regularly clean, maintain, and maintain the product;
- When cleaning the lamp, please use a soft cloth dipped in soapy water to wring it dry and then wipe it clean with a soft and clean cloth;
- Do not use volatile chemical liquids such as alcohol, gasoline, or insecticides for wiping, as this may cause damage to the lighting fixtures, This will affect the lifespan of the lamp.

Cautions:

- The product must be installed before it can be powered on
- Under no circumstances should lamps be directly installed on the surface of ordinary combustible materials;
- Please do not use any objects to obstruct the lighting fixtures;
- Do not use the product in a closed environment;
- Maintenance of lighting fixtures must be carried out by professional technical personnel, and non professional personnel are not allowed to remove the lighting fixtures;
- The external wiring of this lamp adopts an X-shaped connection. If the external flexible cable or flexible cable of this lamp is damaged, the cable should be used
- Replacement of flexible cables or cords specifically provided by manufacturers or their service agents;
- The light source inside this lamp should be replaced by the manufacturer or its service agent or someone with similar qualifications.
- Declaration: The LED street light meets the non hazardous requirements of the photobiosafety standard IEC 62471:2006;
- The product specifications are subject to change without prior notice.



Warning, electric shock hazard

- Headquarters address: Building A, No. 112 Yongfu Road, Qiaotou Community, Fuyong Street, Bao'an District, Shenzhen
- Factory address: Zhouming Science and Technology Park, No. 6 Lanjing North Road, Pingshan District, Shenzhen
- Tel: 0755-29918999
- Fax: 0755-29912092
- Website: www.unilumin.com